

# Male Stud Elbow Couplings

**WE-N**

Dimensions in mm

DIN Fittings

Metric Tube end as per ISO 8434  
and NPTF stud end

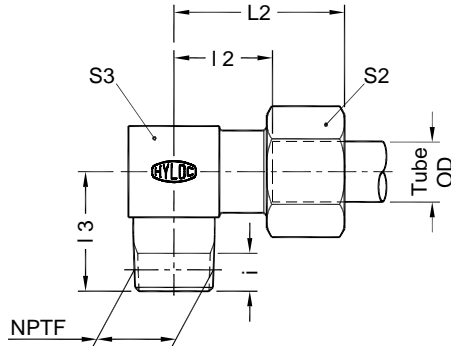

Part No.	Series	Tube od	Male NPTF thread	i	l2	l3	* L2	S2	S3
<b>WE06PLN</b>	<b>Light L</b> 250 bar	6	1/8-27	9.9	12.0	20	27.5	14	12
<b>WE08PLN</b>		8	1/4-18	15.1	14.0	26	29.0	17	14
<b>WE10PLN</b>		10	1/4-18	15.1	15.0	28	30.5	19	17
<b>WE12PLN</b>		12	3/8-18	15.2	17.0	30	32.0	22	19
<b>WE15PLN</b>		15	1/2-14	19.8	21.0	37	37.0	27	22
<b>WE18PLN</b>	160 bar	18	1/2-14	19.8	23.5	40	40.5	32	27
<b>WE22PLN</b>		22	3/4-14	20.1	27.5	42	44.5	36	30
<b>WE28PLN</b>	100 bar	28	1- 11 1/2	25	30.5	50	48.5	41	36
<b>WE35PLN</b>		35	1.1/4-11 1/2	25.6	34.5	56	57.5	50	46
<b>WE42PLN</b>		42	1.1/2-11 1/2	26	40.0	62	63.5	60	55
<b>WE06PSN</b>	<b>Heavy S</b> 630 bar	6	1/4-18	15.1	16.0	26	31.5	17	14
<b>WE08PSN</b>		8	1/4-18	15.1	17.0	28	32.0	19	17
<b>WE10PSN</b>		10	3/8-18	15.2	17.5	30	34.5	22	19
<b>WE12PSN</b>		12	3/8-18	15.2	21.5	31	38.0	24	22
<b>WE16PSN</b>		400 bar	16	1/2-14	19.8	24.5	39	43.5	30
<b>WE20PSN</b>	20		3/4-14	20.1	26.5	43	49.0	36	30
<b>WE25PSN</b>	25		1-11 1/2	25	30.0	54	55.0	46	36
<b>WE30PSN</b>	250 bar	30	1.1/4-11 1/2	25.6	35.5	56	63.5	50	46
<b>WE38PSN</b>		38	1.1/2-11 1/2	26	41.0	62	72.5	60	55

\* Dimensions given are approx figures with tightened nut.