

Male female Adaptors

MFA - S - G

Dimensions in mm

DIN Fittings

Male thread : UN/UNF (SAE)
with O-Ring sealing (NBR 90 Shore)
Female thread : BSPP (G)

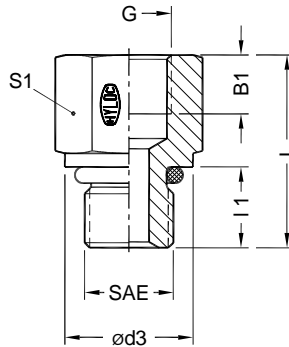

Part No.	Male SAE Class 2A	Female thread 'G'	ød3	I 1	B1	L	S1	O - Ring
MFAS02G01	5/16" - 24	G 1/8	11.0	7.5	9	24	17	6.07 x 1.63
MFAS03G01	3/8" - 24	G 1/8	13.0	7.5	9	24	17	7.65 x 1.63
MFAS04G02	7/16" - 20	G 1/4	14.5	9	13	32	22	8.92 x 1.83
MFAS05G02	1/2" - 20	G 1/4	16.0	9	13	32	22	10.52 x 1.83
MFAS06G02	9/16" - 18	G 1/4	17.5	10	13	34	22	11.89 x 1.98
MFAS08G03	3/4" - 16	G 3/8	22.0	11	13	34	27	16.36 x 2.21
MFAS10G04	7/8" - 14	G 1/2	25.5	13	15	40	30	19.18 x 2.46
MFAS12G06	1.1/16" - 12	G 3/4	32.0	15	17	45	36	23.47 x 2.95
MFAS14G08	1.3/16" - 12	G 1	35.0	15	19	50	46	26.62 x 2.95
MFAS16G08	1.5/16" - 12	G 1	38.0	15	19	50	46	29.74 x 2.95
MFAS20G10	1.5/8" - 12	G1.1/4	48.0	15	21	55	55	37.47 x 3.00
MFAS24G12	1.7/8" - 12	G1.1/2	54.0	15	23	55	60	43.69 x 3.00
MFAS32G16	2.1/2" - 12	G 2	70.0	15	25	60	75	59.36 x 3.00