

# Male Stud Elbow Couplings

WE-R

Dimensions in mm

DIN Fittings

Metric Tube end as per ISO 8434  
and BSP Taper (R) stud end

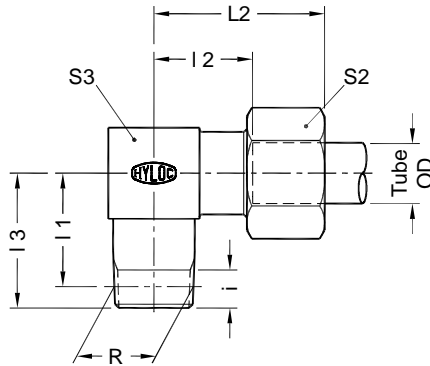

Part No.	Series	Tube od	R Male BSPT thread	i	I 1 min	I 1 max	I 2	I 3	* L2	S2	S3
<b>WE06PLR</b>	<b>Light L</b> 250 bar	6	R 1/8	7.5	16.1	17.9	13	21.0	28.5	14	12
<b>WE08PLR</b>		8	R 1/4	11	20.2	22.8	15.5	27.5	30.5	17	14
<b>WE10PLR</b>		10	R 1/4	11	19.7	22.3	15	27.0	30.5	19	17
<b>WE12PLR</b>		12	R 3/8	11.5	20.3	22.9	17	28.0	32.0	22	19
<b>WE15PLR</b>		15	R 1/2	15	25.0	28.6	22	35.0	38.0	27	22
<b>WE18PLR</b>	160 bar	18	R 1/2	15	26.0	29.6	23.5	36.0	40.5	32	27
<b>WE06PSR</b>	<b>Heavy S</b> 630 bar	6	R 1/4	11	18.7	21.3	17.5	26.0	33.0	17	14
<b>WE08PSR</b>		8	R 1/4	11	19.7	22.3	17	27.0	32.0	19	17
<b>WE10PSR</b>		10	R 3/8	11.5	20.3	22.9	17.5	28.0	34.5	22	19
<b>WE12PSR</b>		12	R 3/8	11.5	20.3	22.9	21.5	28.0	38.0	24	22
<b>WE16PSR</b>		400 bar	16	R 1/2	15	23.5	27.1	26	33.5	45.0	30

\* Dimensions given are approx figures with tightened nut.